



PLUS®
HIGH EFFICIENCY
PRESSURE FEED GUN

Order No. Model No.
110266 JGA-570-10

Order No. Model No.
110272 PLUS-514P-12

High Efficiency
Superior Atomization
Handles Difficult
Materials and
Delivers Superior
Finishes



NEW!
Anodized
Finish

PLUS® High Efficiency Pressure Feed Guns

Order No. Model No.	Air Cap	Fluid Tip (mm)	Inlet Pressure	Application	Fluid Flow
110266 JGA-570-10	#410 (HE)	1.0	30-50 PSI 25-35 PSI	Medium solids Enamels and primers	6-10 oz./min.
110272 PLUS-514P-12	#414 (HE)	1.2	60-65 PSI	High solids	7-14 oz./min.

PLUS® Pressure Feed High Efficiency Air Caps

#410 air cap (HE)	Primers, base coats, clearcoats, single stage, and low VOC Air Cap Order No. 192174 Air Cap Model No. AV-440-410 30-50 PSI 9-12 CFM Fluid tip 1.0 mm	Air Cap Pattern 12½"
#414 air cap (HE)	High solids Air Cap Order No. 192312 Air Cap Model No. AV-440-414 60-65 PSI inlet 19-22 CFM Fluid tip 1.2 mm	Air Cap Pattern 11-14"
Fluid Tips	1.0 mm, 1.2 mm, 1.3 mm, 1.4 mm	

Refer to Service Bulletin: SB-2-475

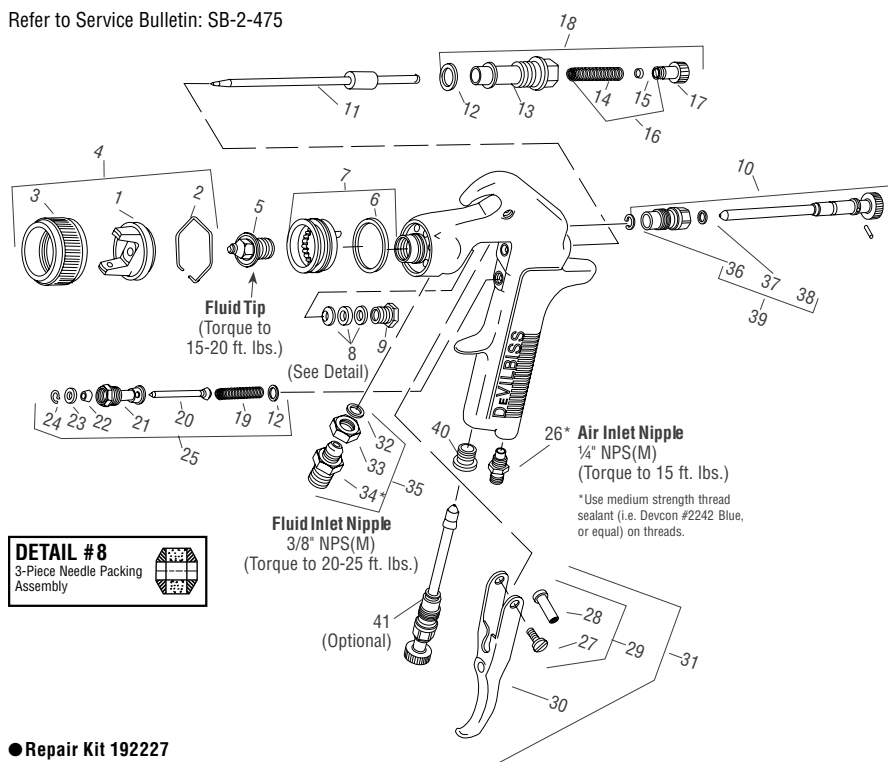

● Repair Kit 192227 (KK-5058-2)

Ref. No.	Description	Qty.
6	Baffle Seal	1
8	Packing	1
12	Gasket Kit	2
14	Fluid Needle Spring	1
15	Spring Pad	1
19	Air Valve Spring	1
20	Air Valve	1
22	U Cup Seal	1
23	Washer	1
24	Snap Ring	1
32	Fluid Cup Gasket	1
36	Retaining Clip	1
37	Seal	1
38	Pin	1

Chart 1: Air Cap

No. on Air Cap	Air Cap Order No.	Air Cap Model No.
410	192174	AV-440-410
414	192312	AV-440-414

Setup Information by Paint Brand: Request Devilbiss paint company recommendation chart or consult your paint supplier specifications for the material being sprayed.

Chart 2: Fluid Tips and Needles

Tip Size in.	Tip Size mm	Fluid Tip (Ref. No. 5)	Suction Feed Fluid Needle (Ref. No. 11)	Pressure Feed Fluid Needle (Ref. No. 11)
0.039	1.0	AV-213-10	NR	GTI-449-12
0.047	1.2	AV-213-12	NR	GTI-449-12
0.055	1.4	AV-213-14	GTI-413	GTI-449-12
0.063	1.6	AV-213-16	GTI-413	NR
0.070	1.8	AV-213-18	GTI-413	NR

NR = Not Recommended

Ref. No.	Order No.	Model No.	Description	Ind. Parts Req.
1	—	—	Air Cap	1
2	191972	JGA-156-K10	Spring Clip (Kit of 10)	1
3	192042	GTI-3	Air Cap Retaining Ring	1
4	—	—	#410 Air Cap and Retaining Ring	1
5	—	See Chart 2	Fluid Tip	1
●6	192179	GTI-33-K5	Baffle Seal (Kit of 5)	1
7	192178	GTI-425	Baffle Assembly	1
●8	192109	JGA-4035-K5	Packing (Kit of 5)	1
9	190893	34411-122-K10	Packing Nut	1
10	192051	GTI-405	Spreader Valve	1
11	—	See Chart 2	Fluid Needle	1
●12	190161	JGS-72-K10	Gasket Kit (PTFE) (Kit of 10)	2
13	—	—	Body Bushing	1
●14	—	—	Fluid Needle Spring	1
●15	—	—	Spring Pad	1
16	190894	MBD-19-K10	Spring and Pad (Kit of 10)	1
17	192043	GTI-414	Needle Adjusting Screw	1
18	192139	KK-5059	Bushing, Spring, Pad and Knob Kit	1
●19	—	—	Air Valve Spring	1
●20	—	—	Air Valve	1
21	—	—	Air Valve Body	1
●22	—	—	U Cup Seal	1
●23	—	—	Washer	1
●24	—	—	Snap Ring	1
25	190780	JGS-449-1	Air Valve Assembly	1
26	190287	P-MB-51	Air Inlet Nipple 1/4" NPS(M)	1
27	—	—	Trigger Stud Screw	1
28	—	—	Trigger Stud	1
29	190889	JGS-478	Stud and Screw Kit	1
30	—	—	Trigger	1
31	191943	JGS-477-1	Trigger Stud, Screw Kit	1
●32	—	—	Fluid Inlet Gasket (PTFE)	1
33	—	—	Locknut	1
34	—	—	Fluid Inlet Adapter	1
35	190888	JGA-4042	Fluid Inlet, Gasket, Nut Kit	1
●36	—	—	Retaining Clip	1
●37	—	—	Seal	1
●38	—	—	Pin	1
39	192229	GTI-428-K5	Clip, Seal & Pin (Kit of 5 Each)	1
40	190828	JGA-132	Plug	1
41	192228	GTI-415	Air Adjusting Valve (Optional)	1