

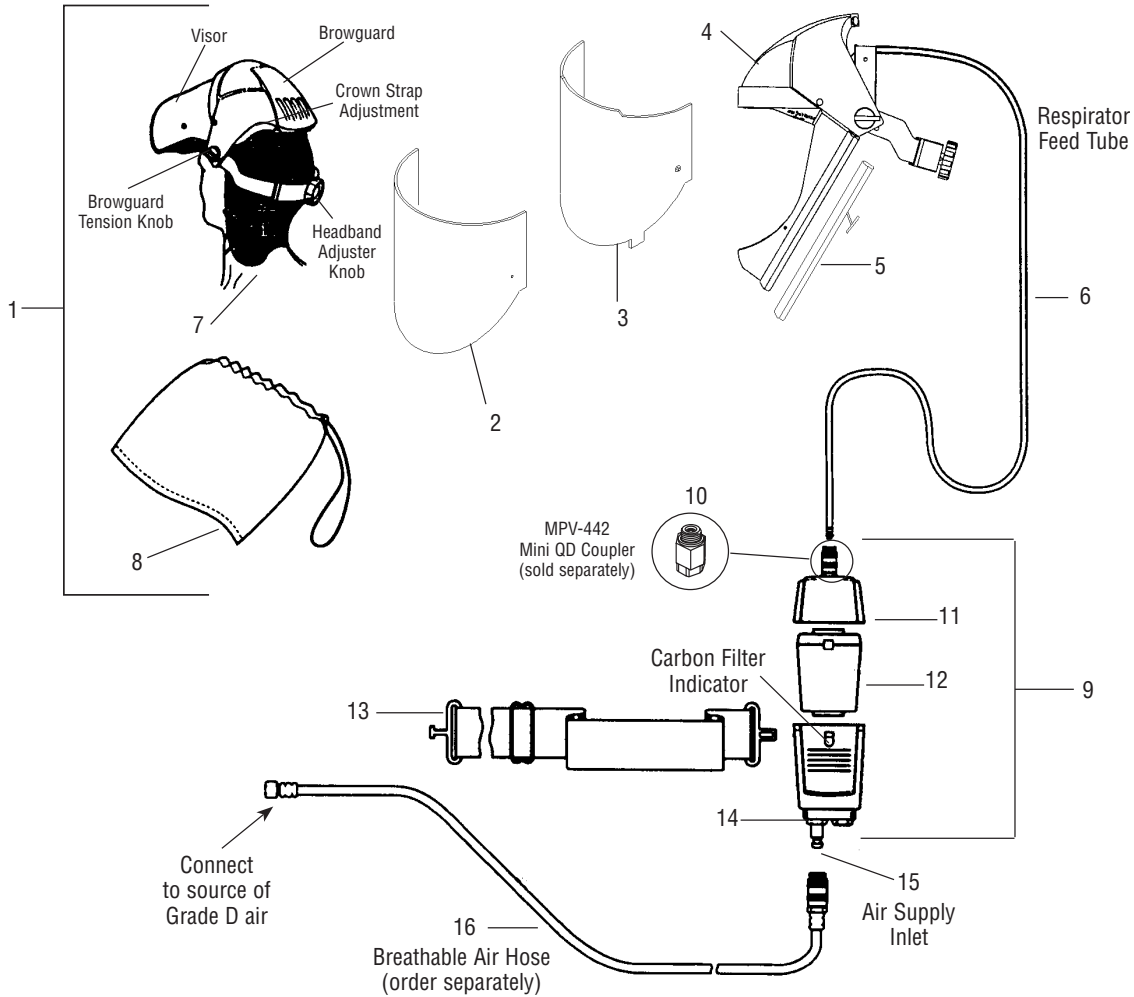

Air Vizor™

PARTS AND ASSEMBLY

Refer to Service Bulletin: SB-25-050



SPECIFICATIONS:

Operating inlet air pressure range: 45 PSI–100 PSI
 Nominal flow rate to Vizor: 6.5 CFM
 Maximum operating temperature: 105°F

Ref. No.	Order No.	Model No.	Description	Ind. Parts Req.
1	165015	MPV-480	Visor Assembly (Includes #'s 2-8)	1
2	165018	MPV-44-K10	Visor Cover (Kit of 10)	2
3	165035	MPV-490	Visor Window	1
4	165021	MPV-483	Browguard Assembly	1
5	165034	MPV-49	Fabric Face Seal	1
6	165001	MPV-457	Tube & Diffuser Assembly	1
7	165007	MPV-24	Hair & Neck Cover	1
8	—	—	Storage Bag	1
9	160014	MPV-469	Waist Belt/Filter Assembly (Includes #'s 10-12)	1
10	165036	MPV-442	Mini QD Coupler	1
11	160017	MPV-472	Regulator & Housing	1
12	160029	MPV-22	Disposable Carbon Filter	1
13	165041	MPV-4005	Waist Belt w/oRegulator	1
14	—	—	Waistbelt & Filter Housing	1
15	165032	MPV-10	Air Inlet Quick Disconnect Stem	1
16	160015	MPV-530	30 ft. Breathable Air Hose Assembly	1
	160016	MPV-550	50 ft. Breathable Air Hose Assembly	1